

# FLAIR

## NM series

### SUPER FLEXIBLE COUPLINGS



### DIMENSIONAL CODE:

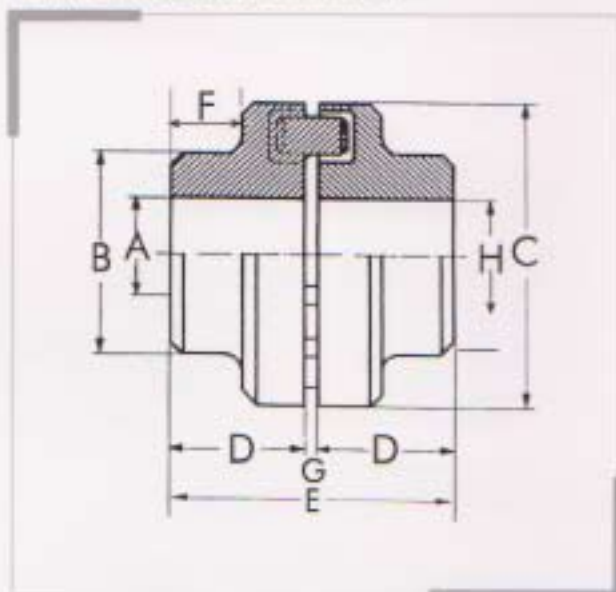

Unit:mm

Model No.	Centre bore (A)	Bore diameter		Teeth	Boss diameter (B)	diameter (C)	Boss height (F)	One side height (D)	All height (E)	kg	Net kg
		Min.	Max.								
NM-50	6	8	19	4	33	50	13	25	52	0.22	0.45
NM-67	8	10	28	4	46	67	15	30	62.5	0.45	0.92
NM-82	8	10	32	4	53	82	24	40	83	0.82	1.68
NM-97	10	12	42	5	69	97	30	50	103	1.65	3.37
NM-112	15	19	48	6	79	112	38	60	123.5	2.49	5.05
NM-128	21	24	55	6	90	128	45	70	143.5	3.86	7.86
NM-148	15	18	65	7	107	148	52	80	163.5	6.05	12.35
NM-168	25	28	75	8	124	168	56	90	183.5	8.95	18.35
NM-194	30	32	85	9	140	194	62	100	203.5	13.1	26.45
NM-214	35	38	95	9	157	214	68	110	224	18.3	36.9

Model No.	Torque		Max. R.P.M.	Permissive tolerance between shafts			GD <sup>2</sup> value for kg-m <sup>2</sup>
	Normal TK Nm	Max. TK Nm		Axial	Radial	Angle	
NM-50	1.4	2.3	12,500	2±0.5	0.6±0.2	2°	0.0001
NM-67	2.3	4	10,000	2.5±0.5	0.8±0.2	2°	0.0002
NM-82	5.2	9	8,000	3±1	0.8±0.2	2°	0.0006
NM-97	10.8	19	7,000	3±1	1±0.2	2°	0.0016
NM-112	17.3	30	6,000	3.5±1	1±0.2	2°	0.0032
NM-128	27.8	48	5,000	3.5±1	1.2±0.2	2°	0.0065
NM-148	42.7	75	4,500	3.5±1	1.2±0.2	2°	0.0135
NM-168	71.2	125	4,000	3.5±1.5	1.2±0.2	2°	0.0258
NM-194	114.6	201	3,500	3.5±1.5	1.5±0.2	2°	0.0518
NM-214	171	300	3,000	4±2	1.5±0.2	2°	0.0855